

# Platinum Suite LEVEL 1-3

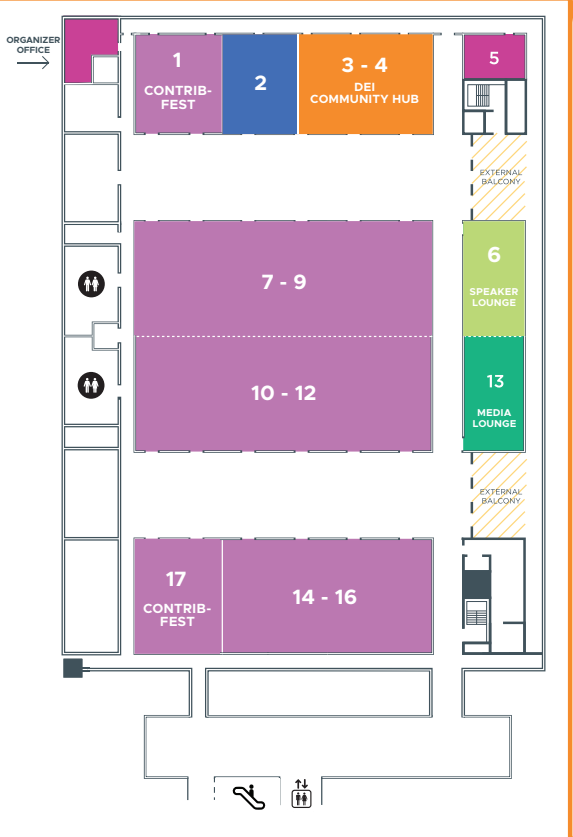

# ICC Capital Suite LEVEL 3



# Prince Regent Rooms LEVEL 1

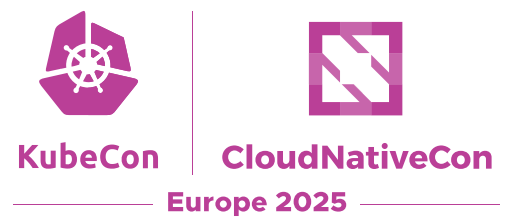
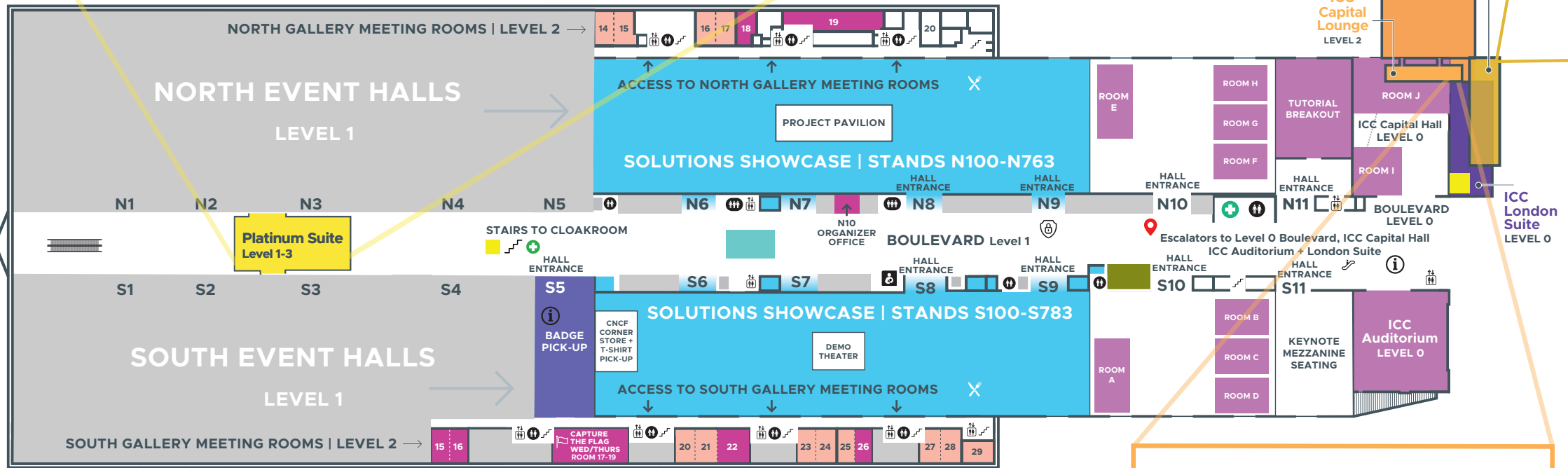
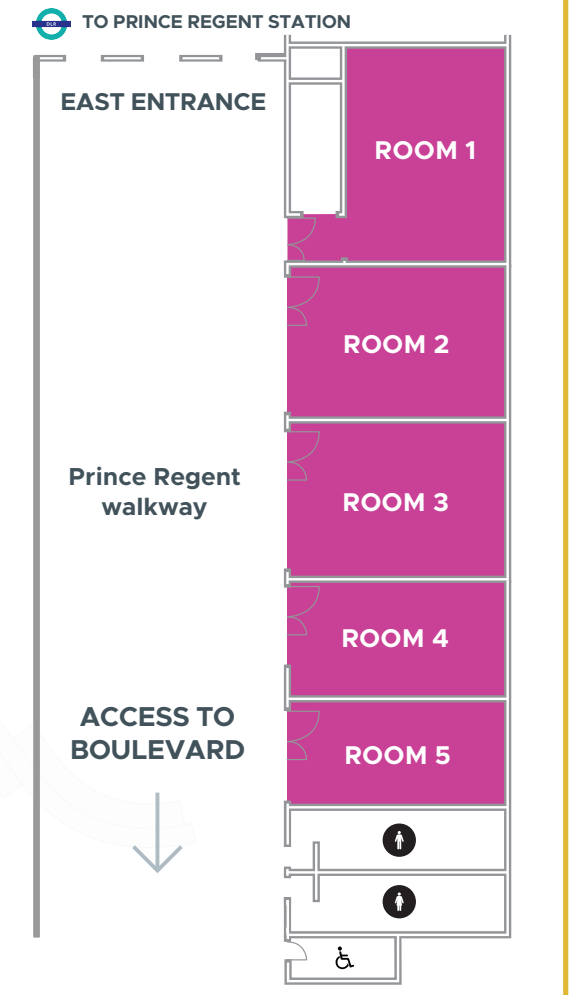

# VENUE MAP

#KUBECON #CLOUDNATIVECON

## KEY

- GENDER NEUTRAL TOILETS
- ELEVATOR
- ESCALATOR
- FIRST AID STATION
- INFO DESK
- FAMILY ROOM
- LUNCH PICK-UP WEDNESDAY-FRIDAY
- TOILETS
- SAFETY AND LOST + FOUND DESK
- STAIRS
- THE MEETING POINT
- AMBASSADOR + MAINTAINER + KUBESTRONAUT LOUNGE | LEVEL 1 | BRIDGE BAR ON BOULEVARD
- AMBASSADOR + MAINTAINER + KUBESTRONAUT WORKSPACE | LEVEL 3 | ICC CAPITAL SUITE 2
- BADGE PICK-UP | HALL ENTRANCE S5
- BREAKOUT ROOMS
- CLOAKROOM
- DEI COMMUNITY HUB | LEVEL 3 | ICC CAPITAL SUITE 3-4
- MEDIA LOUNGE | LEVEL 3 | ICC CAPITAL SUITE 13
- MEETING ROOMS
- SPONSOR MEETING ROOMS
- ONSITE RESOURCES
- SPEAKER LOUNGE | LEVEL 3 | ICC CAPITAL SUITE 6

# ICC Capital Lounge Meeting Rooms LEVEL 2

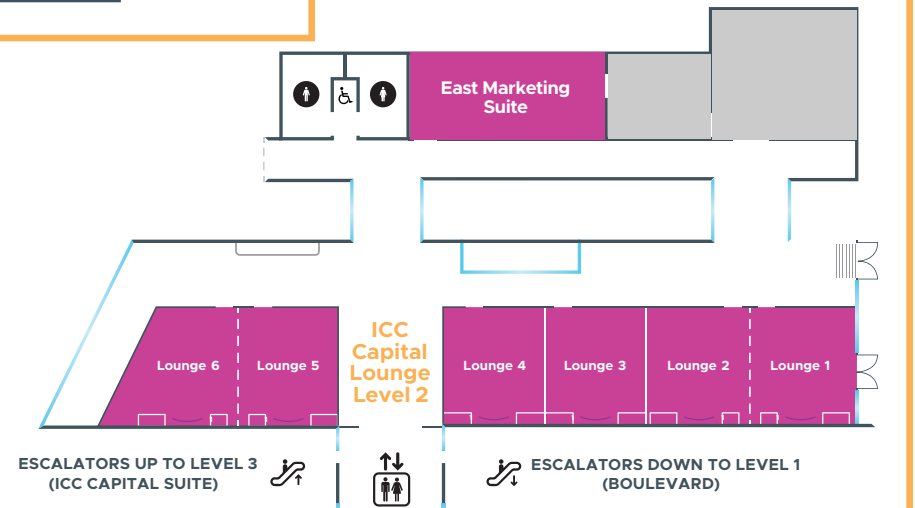

**VENUE MAPS**

**ONSITE RESOURCES**

**WI-FI**

NETWORK: KubeConCloudNativeCon  
PASSWORD: cloudnative



# ONSITE RESOURCES

## QUIET ROOMS

### PLATINUM SUITE | LEVEL 3

Titanium Room | A physical space where all attendees can go if they feel unable to interact with other attendees for a period of time.

Zinc Room | A physical space where women + non-binary attendees can go if they feel unable to interact with other attendees for a period of time.

Please refrain from conversation, interaction, or work in these spaces.

## PRAYER ROOM

Located on Level 1 and can be accessed through the grey door next to Hall Entrance S9 in the Boulevard. This is a space for prayer for all attendees. Please refrain from conversation, interaction, or work in this room.

## NURSING ROOM / FAMILY ROOM

Located by Hall Entrance S9 on Level 1.

## GENDER NEUTRAL TOILETS

- Level 0 | Between Hall Entrances N6 + N7
- Level 0 | Between Hall Entrances N7 + N8
- Level 0 | Between ICC Capital Hall + Auditorium towards the Car Parks

## FIRST AID

- Level 0 | Accessible via the staircase between Hall Entrances N4 + S4
- Level 1 | By Hall Entrance N10

## CAPTIONING

Accessible via Wordly on your personal device.

## HOW TO HANDLE A HARASSMENT REPORT

If you are being harassed, notice that someone else is being harassed, or have other concerns, contact an event staff member immediately. Event staff can be identified by staff badges and/or shirts and can be found at the event registration counter during event hours. You can also email us at [eventconduct@cncf.io](mailto:eventconduct@cncf.io).